

EVEREST SUPER SERIES BLOWERS

NEW RANGE BY EVEREST

At Everest blowers we produce the yardstick of quality which is not by accident, but ..always a result of intelligent efforts.

- ★ Internal of SG Iron, failsafe labyrinth sealing with anti friction bearings.
- ★ Only small & Hi-tech blower in India which can operate under high differential Pressure, in simple air cooled arrangement
- ★ Very Low transmission Loses

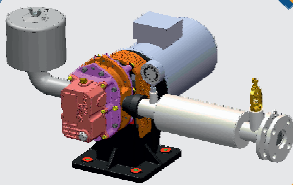

**EVEREST
BLOWERS MEANS
TROUBLE FREE
OPERATIONS**

**READY
MACHINES ,
JUST PLUG &
PLAY.**



NEW FEATURES

- Rugged direct drive machine operates (Can operate up to 5000 rpm.)
- Compact design inherent direct coupled machine
- Low noise level under 80 dB(a).
- Less power consumption.
- Easy installation.
- Advance machine design, 1st of its kind in the world.
- Lowest noise level & pulsation across the board
- 100% oil free air delivery



SUPER 50	1000mmWC		2000mmWC		3000mmWC		4000mmWC		5000mmWC		6000mmWC		7000mmWC	
	m3/hr	BKW	m3/hr	BKW	m3/hr	BKW	m3/hr	BKW	m3/hr	BKW	m3/hr	BKW	m3/hr	BKW
	59	0.4	53	0.6	51	0.9	45	1.1	41	1.2	37	1.5	34	1.7

DESIGN & TECHNICAL FEATURES SUPERSERIES® BLOWERS

CASING : All Everest Blowers units are single-piece construction and precision machine cast iron, with rib for strength and consistent thermal behaviour.

SHAFT : Rotor shafts are alloy higher operating pressure and rotation speeds

MOUNTING BRACKET: Mounting bracket for anchoring.

ROTORS: Made from cast iron or SG iron, stainless steel with stiff design for maximum life. By CNC and 3D machinery control to insure the highest performance providing with trouble free performance and durability

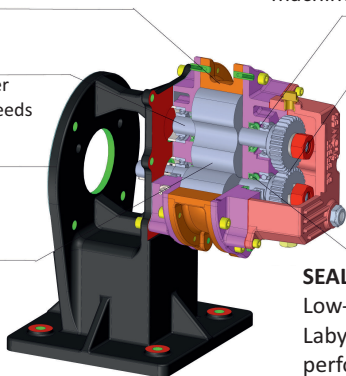

BEARING: All Everest Blower units are using SKF/FAG Eqv. Beaing with long life, Anti-Friction type vary with machine.

TIMING GEAR : Forged steel gear with hardened and ground spur teeth to reduced vibration and ensure accurate rotor to rotor timing for smooth and efficient operation

SEAL: Low-Wear, non-contacting, Labyrinth - type scals insure performance and long life.

APPLICATIONS

- **Water Treatment Plant** for backwashing of filter/mixed beds.
- **Effluent Treatment Plant** for diffused aeration and agitation of effluent.
- **Sewage Treatment Plant** for diffused aeration and agitation of sewage.
- **Aquaculture** for maintaining the dissolved Oxygen level.
- **Electroplating Plant** for Oil Free air agitation of electrolyte.
- **Pneumatic Conveying** Vacuum, Pressure and Combination Conveying of cereals, cement, husk, baggase, granules, powders and other similar material.
- Swimming pool & Jacuzzi for bubbling/ aeration

Fit & Forget - Everest Superseries® Blowers



Corporate Office
+91 11 45457777



Sales
enquiry@everestblowers.com



Corporate Office
B-44, Mayapuri Industrial Area, Phase 1, New Delhi 110064, India
Factory
Plot No. 82-83, Sector 16, HSIIDC, Bahadurgarh 124507, Haryana, India
ISO 9001:2015 | ISO14001:2015 | OHSAS 18001:2007 Certified



Web
www.everestblowers.com



Marketed & Serviced By:

We don't just offer
"Blowers, Vacuum Pumps and Compressors"
we offer **Energy Saving Solutions !!!**